



FRAME SCAFFOLDING EURO+



1. Steel frame

Frame is made of $\varnothing 48,3$ mm pipe, wall thickness 2,7mm. Upper u-profile allows to put two steel planks 32cm wide or one aluminum – plywood plank 61cm wide. For elimination of terrain irregularities there are 0,66m, 1,0m and 1,5m height compensating frames.

Article no	Dimensions (m)	Weight (kg)
RFS-07067*	0,66 x 0,73	10,0
RFS-07101	1,00 x 0,73	12,76
RFS-07151*	1,50 x 0,73	15,6
RFS-07203	2,00 x 0,73	19,82



2. Bypass steel frame*

Made of tube with a diameter of 48.3mmx2.7. It is used to bypass cornices, etc.

Article no	Dimensions (m)	Weight (kg)
RFS-07211	2,00 x 0,73	23,50



3. Aluminum frame

Made of $\varnothing 48,3$ mm pipe, will thickness 4mm. It is twice lighter than a steel frame, speeds up assembly and disassembly of scaffolding construction.

Article no	Dimensions (m)	Weight (kg)
RFA-07066	0,66 x 0,73	5,1
RFA-07100	1,00 x 0,73	6,4
RFA-07150	1,50 x 0,73	8,2
RFA-07200	2,00x0,73	9,7



4. Steel front frame

Frame ensures security of front fields on the highest level of the scaffolding.

Article no	Dimensions (m)	Weight (kg)
RFS-00073	1,0 x 0,73	12,06



5. Aluminum front frame

It is a lighter version of steel front frame.

Article no	Dimensions (m)	Weight (kg)
RFA-00073	1,0 x 0,73	6,9



**make to order only

6. Steel pass-by frame**

This frame ensures security for pedestrians going under assembled scaffolding.

Article no	Dimensions (m)	Weight (kg)
RFS-27200	1,5 x 2,0	35,9



7. Steel handrail post with plank protection

Handrail post ensures security on the highest level of the scaffolding. Post has couplings where handrails are installed. Lower part of post prevents unwanted plank removing

Article no	Dimensions (m)	Weight (kg)
RFS-40073	1,0 x 0,73	5,48



8. Aluminum handrail post with plank protection 0,73m

It is a lighter version of steel handrail post.

Article no	Dimensions (m)	Weight (kg)
RFA-40073	1,0 x 0,73	3,3



9. Steel handrail post

Post is recommended for installation on the highest level of the scaffolding.

Article no	Dimensions (m)	Weight (kg)
RFS-04073	1,00	4,22
RFS-11074	2,00	8,9



10. Aluminum handrail post

It is a alternative version of steel handrail post.

Article no	Dimensions (m)	Weight (kg)
RFA-04073	1,0	2,2



**make to order only

11. Net screen post

Post is designed for installing protective net on the highest level of the scaffolding

Article no	Dimensions (m)	Weight (kg)
RFS-11073	2,0 x 0,73	9,26



12. Mobile beam**

Designed to assemble mobile tower with facade scaffolding.

Article no	Dimensions (m)	Weight (kg)
RFS-03073	0,73	26,3

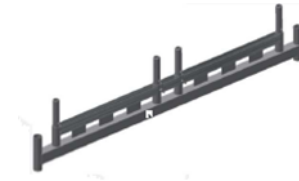

13. Front handrail

Front railing ensures security of front fields on the intermediate levels of the scaffolding.

Article no	Dimensions (m)	Weight (kg)
RFS-15073	0,73	3,82



14. Single handrail

Made of \varnothing 38 mm steel pipe. Stiffens and stabilizes construction of the scaffolding. Designed to ensure security of scaffolding users.

Article no	Dimensions (m)	Weight (kg)
RFS-01073	0,73	1,56
RFS-01109	1,09	2,05
RFS-01157	1,57	3,14
RFS-01207	2,07	3,44
RFS-01257	2,57	4,04
RFS-01307	3,07	4,90



**make to order only

15. Double aluminum handrail

Stiffens scaffolding construction.
Replaces two simple handrails.

Article no	Dimensions (m)	Weight (kg)
RFA-01157	1,57	3,4
RFA-01207	2,07	4,2
RFA-01257	2,57	5,0
RFA-01307	3,07	5,8



16. Double aluminum concentric handrail

Indeks	Wymiar (m)	Waga (kg)
RFA-02157	1,57	3,9
RFA-02207	2,07	4,6
RFA-02257	2,57	6,57
RFA-02307	3,07	7,48



17. U - aluminum-plywood deck

Frame of plank is made of aluminium, the surface is finished with anti-slip plywood. Aluminium-plywood plank is alternative for two steel deck.

Article no	Dimensions (m)	Weight (kg)
RFA-61157N	1,57 x 0,61	13,0
RFA-61207N	2,07 x 0,61	17,0
RFA-61257N	2,57 x 0,61	19,5
RFA-61307N	3,07 x 0,61	23,0

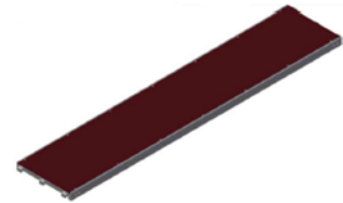

18. U - aluminum-plywood access deck with ladder

This deck ensures access to upper levels of scaffolding. Deck has a hatch and aluminium ladder.

Article no	Dimensions (m)	Weight (kg)
RFA-60257N	2,57 x 0,61	26,5
RFA-60307N	3,07 x 0,61	29,5



**make to order only

19. U - aluminum - plywood access deck without ladder

Enables vertical communication inside the scaffolding.

Article no	Dimensions (m)	Weight (kg)
RFA-62157	1,57 x 0,61	17,1
RFA-62207	2,07 x 0,61	20,1
RFA-62257	2,57 x 0,61	23,1
RFA-62307	3,07 x 0,61	26,1



20. U - aluminum- plywood access deck with steel hooks

Supporting structure of the deck made of aluminum. Filling the deck made of waterproof plywood with non-slip surface. An aluminum and plywood bridge replaces two steel bridges. Completed with brackets for mounting on the U-ledger.

Article no	Dimensions (m)	Weight (kg)
RFA-61157	1,57 x 0,61	13,0
RFA-61207	2,07 x 0,61	17,0
RFA-61257	2,57 x 0,61	19,5
RFA-61307	3,07 x 0,61	23,0

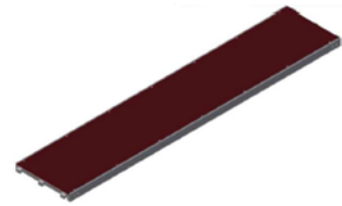

21. U - aluminum - plywood access deck with ladder and steel hooks

Enables vertical communication inside the scaffolding.

Article no	Dimensions (m)	Weight (kg)
RFA-60257	2,57x0,61	26,5
RFA-60307	3,07x0,61	29,5



22. U - steel deck

Steel deck is made of steel plate, hot-dip galvanized. Round perforation, ended with hooks for installation on u-profile of frame. Nominal load depending on length of plank is up to 5 kn/m².

Article no	Dimensions (m)	Weight (kg)
RFS-84073	0,73 x 0,32	5,40
RFS-84109	1,09 x 0,32	7,50
RFS-84157	1,57 x 0,32	10,10
RFS-84207	2,07 x 0,32	13,36
RFS-84257	2,57 x 0,32	15,50
RFS-84307	3,07 x 0,32	18,90



**make to order only

23. U - steel deck with crossbars

Steel deck is perforated, on the other side there is crosspieces for easier assembly and disassembly of scaffolding.

Article no	Dimensions (m)	Weight (kg)
RFS-85157	1,57 x 0,32	10,0
RFS-85207	2,07 x 0,32	13,7
RFS-85257	2,57 x 0,32	16,0
RFS-85307	3,07 x 0,32	18,9



24. U - alu grooved access deck with ladder**

Article no	Dimensions (m)	Weight (kg)
RFA-70257LN	2,57	6,5
RFA-70307LN	3,07	10,5



25. U - aluminum deck with crossbars**

Perforated aluminium deck with crossbars for easier assembly and disassembly. Completed with brackets for mounting on the U-profile.

Article no	Dimensions (m)	Weight (kg)
RFA-32157N	1,57	6,50
RFA-32207N	2,07	7,80
RFA-32257N	2,57	9,20
RFA-32307N	3,07	10,5



26. Triangular steel deck**

Article no	Dimensions (m)	Weight (kg)
RFS-84001	0,32x0,73	13,36
RFS-84010	0,32x0,73	13,36

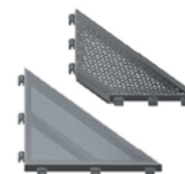

**make to order only

27. Regulated base jack

Base jack on 150x150mm foot with threaded pipe and nut. Flattened thread ensures the nut will not be lost. The maximum regulated height is 40 cm for 60 cm base jack.

Article no	Dimensions (m)	Weight (kg)
RFS-12160	0,6	3,58
RFS-12080	0,8	5,26



28. Diagonal brace

Brace stiffens the construction. Made of \varnothing 42 mm diameter pipe with half coupling on its end

Article no	Dimensions (m)	Weight (kg)
RFS-50207	2,07 x 2,0	6,38
RFS-50257	2,57 x 2,0	6,86
RFS-50307	3,07 x 2,0	7,82

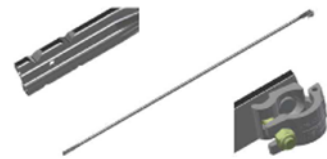

29. Diagonal brace with wedge coupling

Brace stiffens the construction. Instead of half coupling with bolt and nut on the ending is used coupling with wedge.

Article no	Dimensions (m)	Weight (kg)
RFS-54177	1,77	8,2
RFS-54195	1,95	8,8

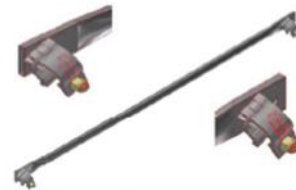

30. Horizontal brace

Horizontal braces are used to stiffen lower level of scaffolding where normal diagonal braces are installed.

Article no	Dimensions (m)	Weight (kg)
RFS-55207	2,07	9,2
RFS-55257	2,57	11,1
RFS-55307	3,07	13,0

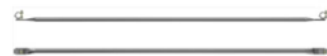

31. Toe board

Wooden toe board, impregnated, finished with steel fittings. Mounted at the height of the platform. It is used to secure working platforms.

Article no	Dimensions (m)	Weight (kg)
RFS-20073	0,73 x 0,15	1,80
RFS-20109	1,09 x 0,15	2,70
RFS-20157	1,57 x 0,15	4,24
RFS-20207	2,07 x 0,15	5,40
RFS-20257	2,57 x 0,15	6,70
RFS-20307	3,07 x 0,15	7,80



**make to order only

32. Toeboard couplings

Article no	Dimensions (m)	Weight (kg)
ZNN-07110	-	0,95



33. Toeboard couplings with wedge

Indeks	Wymiar [m]	Waga [kg]
ZNN-07111	-	0,95



34. Wall tie

The anchoring connector is mounted using two connectors to the stands. Shorter connectors are mounted with one connector to one stand. Used to anchor the scaffolding to the facade of the building.

Indeks	Wymiar [m]	Waga [kg]
RFS-17040	0,4	1,70
RFS-17085	0,85	3,10
RFS-17110	1,1	4,84
RFS-17130	1,3	4,84
RFS-17150	1,5	4,84



35. Eye bolt

It is used to anchor the scaffolding to the wall, used together with an expansion pin.

Article no	Dimensions (m)	Weight (kg)
ZŚR-0120	0,12	0,10
ZŚR-00300	0,3	0,33



36. Security pin

The safety pin protects against the disconnection of steel frames.

Article no	Dimensions (m)	Weight (kg)
RFS-00011	-	0,10



**make to order only

37. Steel ladder

Steel ladder with perforated metal rungs.

Article no	Dimensions (m)	Weight (kg)
RFS-01021	2,15	11,00



38. Stair stringer fall protection 1,00 x 0,50 m, steel, incl. linchpin 12 x 70 m, galvanised

For lateral fall protection of circulating bay when using aluminium stairways.

Article no	Dimensions [m]	Weight [kg]
RFS-32002	1,00 x 0,50	5,25



39. Aluminum stairs

* stairs with perforated steps

Article no	Dimensions (m)	Weight (kg)
RFA-35257N	2,57x0,63	23
RFA-35307N	3,07x0,63	27
RFA-30257 N	2,57x0,63	23
RFA-30307N*	3,07x0,63	27



40. U-Aluminum stairs 1,0 m **

* steps make of perforated sheet

Article no	Dimensions [m]	Weight [kg]
RFA-30100*	1,0x0,64	14,15
RFA-35100	1,0x0,64	14,15



41. Stairway guardrail

Ensures safety while using stairway.

Article no	Dimensions (m)	Weight (kg)
RFA-31257	2,57	16,0
RFA-31307	3,07	17,8

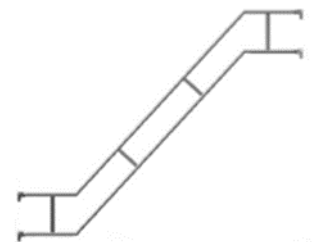

**make to order only

42. Internal stairway guardrail

Mounted in a set with a handrail handle. Enables secure communication on the scaffolding.

Article no	Dimensions (m)	Weight (kg)
RFS-32001	-	11,97

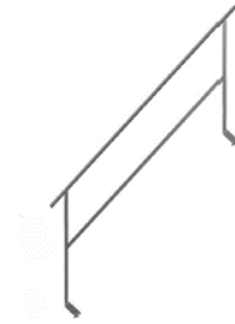

43. Initial u-ledger for stairs

This element is used for supporting stair on the lowest most level of staircase.

Article no	Dimensions (m)	Weight (kg)
RFS-22730	0,73	3,20



44. Transverse U-ledger

Allows you to put deck at any height of frame.

Article no	Dimensions (m)	Weight (kg)
RFS-22073	0,73	3,6



45. U-console bracket with wedge-head

Console is used to widen scaffolding platform. maximum load of console 0,36 m - 3 kN/m², 0,73 m - 1 kN/m². Wide consoles are used with transverse braces.

Article no	Dimensions (m)	Weight (kg)
RFS-12036	0,36	3,64
RFS-12073	0,73	6,22
RFS-12074	0,73 x 2,0	6,30
RFS-12109	1,09	11,9



46. Platform protection

An element protecting the platform against falling out.

Indeks	Wymiar [m]	Waga [kg]
RFS-16036	0,36	0,99
RFS-16073	0,73	1,75
RFS-16109	1,09	2,48



**make to order only

47. Protective roof console**

Console is used to secure pedestrians.
Used together with console 0,73m.

Article no	Dimensions (m)	Weight (kg)
RFS-14073	0,73	5,9



48. Net screen**

Net screen is used on upper level of scaffolding instead of handrails and longitudinal curbs.

Article no	Dimensions (m)	Weight (kg)
RFS-13157	1,57 x 1,0	16,9
RFS-13207	2,07 x 1,0	21,5
RFS-13257	2,57 x 1,0	25,1
RFS-13307	3,07 x 1,0	28,6



49. Steel lattice beams**

Beams is used to assemble platforms, to make hanging platforms to or to make passage under scaffolding construction.

Article no	Dimensions (m)	Weight (kg)
RFS-05324	3,24 x 0,5m	35,5
RFS-05424	4,24 x 0,5m	45,5
RFS-05524	5,24 x 0,5m	54,5
RFS-05624	6,24 x 0,5m	64,0

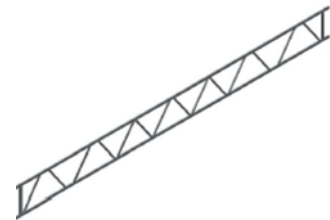

50. Aluminum lattice beams

Is it alternative for steel beams, this beams is easier to assemble and disassemble.

Article no	Dimensions (m)	Weight (kg)
RFA-05324	3,24 x 0,5m	14,2
RFA-05424	4,24 x 0,5m	18,8
RFA-05524	5,24 x 0,5m	22,6
RFA-05624	6,24 x 0,5m	26,4
RFA-05824	8,24 x 0,5m	34,4

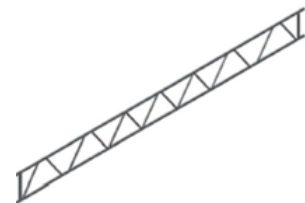

51. Lattice beam connection

Connection is used together with steel and aluminum girders. It allows connecting girders of different length.

Article no	Dimensions (m)	Weight (kg)
RFA-0500	0,4	2,20

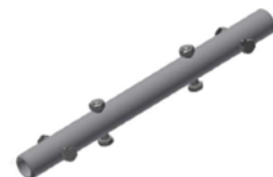

**make to order only

52. Aluminum deck beam**

Beam are installed on girders to make platforms on them.

Article no	Dimensions (m)	Weight (kg)
RFA-21064	0,64	2,7
RFA-21090	0,90	3,3
RFA-21120	1,20	3,8
RFA-21160	1,60	5,2
RFA-21192	1,92	5,8
RFA-21300	3,00	8,5
RFA-21400	4,00	10,2
RFA-21500	5,00	12,7
RFA-21600	6,00	15,2



53. Jib for block

For vertical transport of material components from scaffolding.

Article no	Dimensions (m)	Weight (kg)
RFS-25080	0,8	7,00



54. Modular pallet

Pallet is used for easy transportation and storage of scaffolding elements.

Article no	Dimensions (m)	Weight (kg)
RFS-61280	1,2 x 0,8 x 0,8	26,84
RFS-61282**	1,2X 0,8 x 0,9	28,00
RFS-61290**	1,2 x 0,9	40,0
RFS-60566*	1,2 x 0,9	47,40
RFS-61211**	1,2x1,1x0,94	34,00



55. Modular box**

* A possible option with a galvanized steel insert

Article no	Dimensions (m)	Weight (kg)
RFS-61281	0,8 x 1,2	58,50



**make to order only

56. Net pallet with wooden insert**

It is used for storing and transporting small scaffolding elements. Mounted in a modular pallet. Sold in a set with a wooden floor*

Article no	Dimensions (m)	Weight (kg)
RFS-60567	1,08 x 0,68	30,40

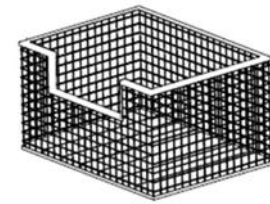

* A possible option with a galvanized steel insert

57. High pallet for facade frames+ security**

Article no	Dimensions [m]	Weight [kg]
RFS-61273	0,8 x 1,2	22,00



58. Low pallet for facade frames 0,8 x 1,2m **

Article no	Dimensions [m]	Weight [kg]
RFS-61274	0,73 x 1,20	19,50



59. Tube pallet 125**

Article no	Dimensions [m]	Weight [kg]
RFS-61285	1250x850x275	35,50



**make to order only

60. Warehouse pallet open version

For high folding in the scope of: frames, steel platforms, handrails, bracing, etc.

Article no	Dimensions [m]	Weight [kg]
RNS-07113	110x70x55 [50X50X3]	31,00



61. Steel assembly frame with 4 guardrail wedge housings**

Article no	Dimensions [m]	Weight [kg]
RFS-07203K	2,00 x 0,73	20,00

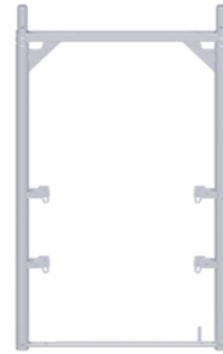

62. Normal coupler

Used to connect pipes at an angle of 90°.

Article no	Dimensions (m)	Weight (kg)
ZNN-ZB02CH	-	1,34



63. Swivel coupler

Used to connect pipes at any angle

Article no	Dimensions (m)	Weight (kg)
ZNN-ZB01CH	-	1,44



64. Handrail coupler with wedge

Article no	Dimensions (m)	Weight (kg)
ZNN-07048	-	0,94



**make to order only

65. Sleeve coupler**

Used to connect two pipes.

Article no	Dimensions (m)	Weight (kg)
ZNN-07049	-	0,70



66. Hook coupler**

The element used to connect the 48.3 steel pipe elements of the supporting structure of the building.

Article no	Dimensions (m)	Weight (kg)
ZNN-07030	-	0,95

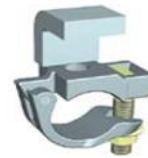

67. Connector + angle bracket

With steel bracket for fixing wooden profiles

Indeks	Wymiar [m]	Waga [kg]
ZNN-07200	-	1,70



update 19/05/2020

**make to order only



Żabokliki, ul. Korczewska 57

08-110 Siedlce

tel. + 48 25 631 03 30

fax. + 48 633 14 16

e-mail: info@olan.siedlce.pl

[WWW. OLAN.SIEDLCE.PL](http://WWW.OLAN.SIEDLCE.PL)